

GUTTER CLIP

Available in 5 & 10mm Thickness



For Extreme Environments

Freezing to fire prone areas



Non-Corrosive Material

Great for coastal areas



Heat Resistant

Rated to BAL-40



Perfect for regutters

Timber & Metal Fascia



**Meets Australian Standards
& Building Codes**

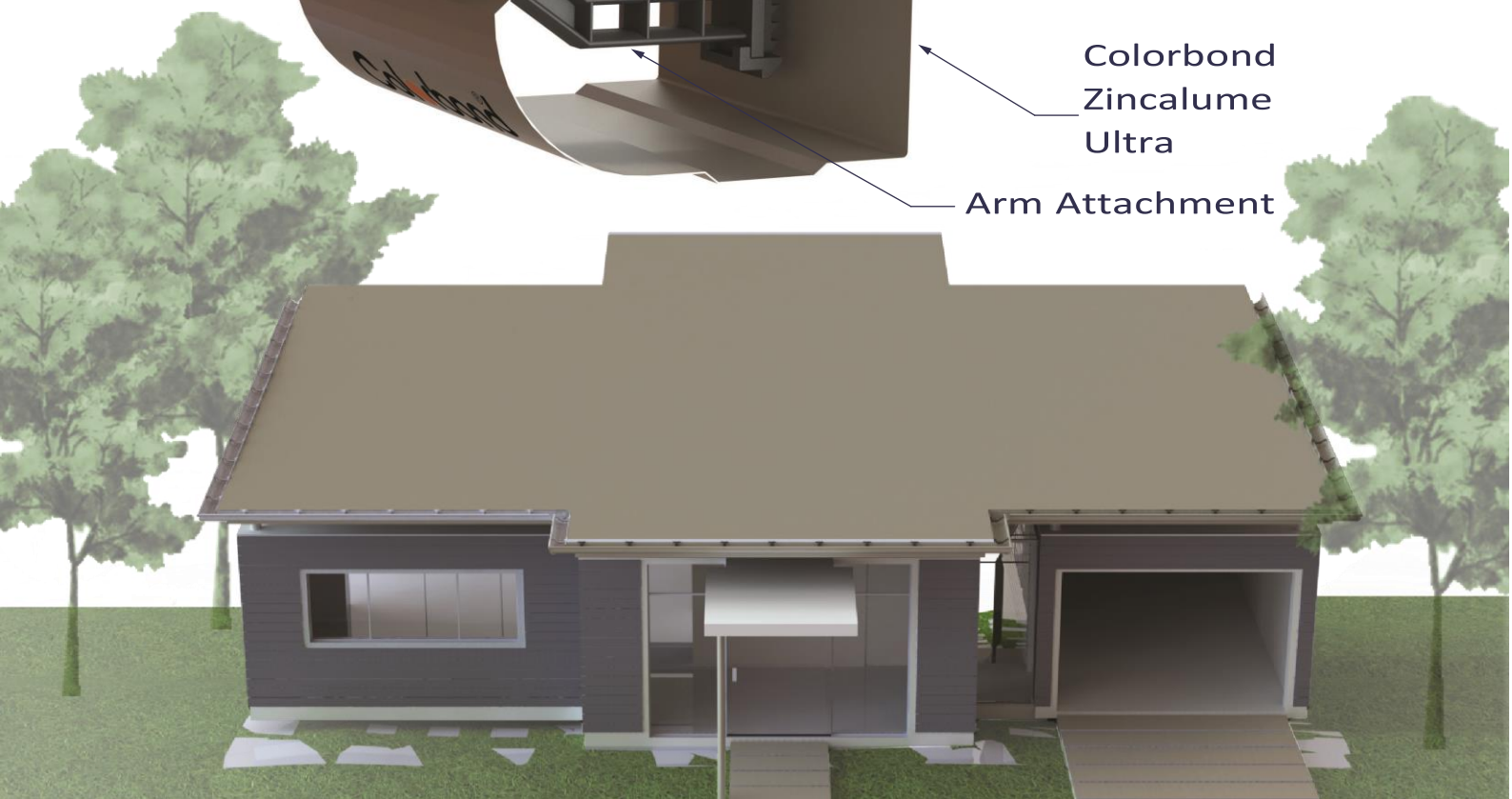
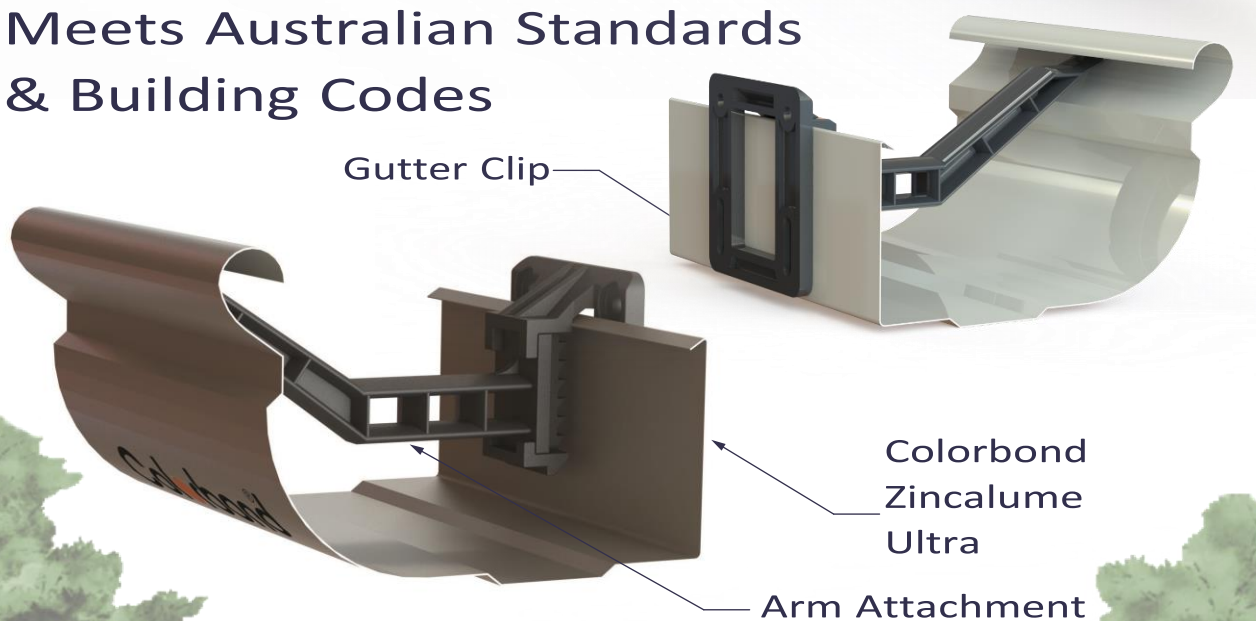

GUTTER CLIP

Made to withstand the most extreme environments this unique patented design is made from the toughest UV stabilised and heat resistant glass reinforced nylon. Designed for ease of installation, with interchangeable arm attachments, this modular product can be used on most types of gutter profiles and metal or timber fascia's; allowing a 5mm & 10mm continuous overflow gap between the back of the gutter and fascia. The guttering can also be set to the desired fall thanks to the inclusion of teeth.

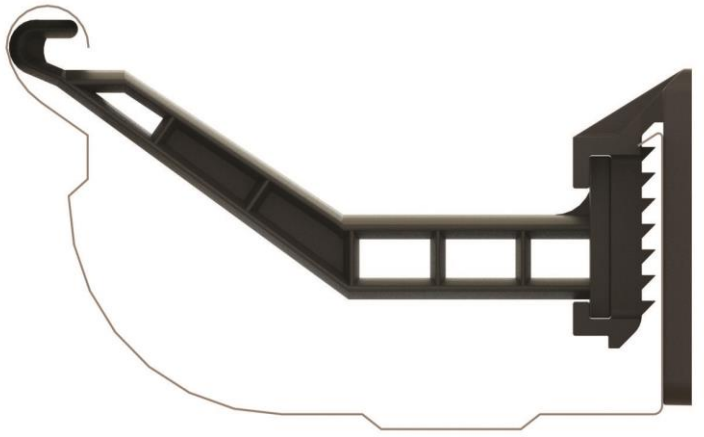

GUIDELINE – INSTALLATION

Step 1 – Insert arm into gutter clip before fixing (regutters only).

Step 2 – Fix gutter clip to fascia with 4 screws.

We recommend not to exceed 750mm spacings between gutter clips.

Step 3 – Determine fall by using the adjusting gutter teeth or a string line.

Step 4 – Hook gutter arm into the bead of the gutter, rotate and slide into the rail at the front of the gutter clip.

Recommended Fasteners

For coastal areas use a high – class Climaseal Coating.

Metal Fascia: 8g x 20mm Button Head Philips Drive Needle Point.

Pine Fascia: 8-10x28mm Bugle Needle Point.

