

KAB[®] 40

SAFETY EDGE

Incorporating a patented design and manufactured from Truecore Zincalume steel, the KAB40 SE range of roof battens provides for faster and more efficient installation. The KAB40 SE range is lightweight and economical and has an extra large surface fixing area and high grip edges that reduce the likelihood of slippage on timber rafters.

The KAB40 SE range will not shrink, warp or twist when placed under a load and delivers a consistently straight performance in any situation. As well as being strong and easy to install, the battens also have a safety edge for the protection of the installer and can be easily cut to your desired size with tin snips.

Utilizing either 0.55mm BMT steel for Cyclonic applications or 0.48mm BMT steel for Non-Cyclonic battens, the KAB40 SE range is consistently the best. Interline Manufacturing produces the leading battens in Australia. The company uses the latest technologies to keep ahead of the rest in both product innovation and quality.

The KAB40 SE (0.55mm BMT) batten has passed the stringent new industry Low-High-Low system of cyclic testing at James Cook University Cyclone Testing Station - the first to do so. Only quality components were used during testing, including TrueCore Steel and Buildex fasteners. KAB40 SE complies with the low-high-low cyclonic testing regime.



KAB40 SE Batten Quantity Calculation

Metres required = $[A + (B + C \times 2)] \div 6.2 + (2 \times L)$

A = Roof area in square metres

B = Ridges

C = Valleys

L = 6.5 metres or required batten length

Check 1.5 TO 1.6 roof area

KAB40 (lengths) = $KAB40 \text{ (metres)} \div 6.5$
(or required batten length)

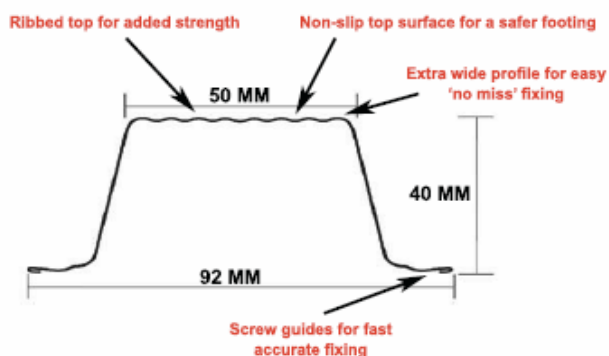

Cyclonic KAB40 SE Roof Batten

Material G550/AZ150 (A S1397)

Mass 0.72 Kg/m

Thickness BMT 0.55mm

Lengths 6.5m + 0.15mm*

Finish TrueCore/Zincalume

Non-Cyclonic KAB40 SE Roof Batten

Material G550/AZ150 (A S1397)

Mass 0.66 Kg/m

Thickness BMT 0.48mm

Lengths 6.5m + 0.15mm*

Finish TrueCore/Zincalume

Recommended Batten Spacing when using .42 and .48 BMT Roof

Corrugated Roof Profile (Grade G550)

| Rafter Spacing (mm) | Type of Span | 0.48mm BMT Non Cyclonic Wind Classification | | | 0.55mm BMT Cyclonic Wind Classification Low-High-Low Certified | | | |
|---------------------|--------------|---|------|------|--|-----|-----|-----|
| | | N1 | N2 | N3 | C1 | C2 | C3 | C5 |
| 450 | End | 900 | 900 | 900 | 830 | 550 | 380 | 280 |
| | Internal | 1200 | 1200 | 1200 | 1200 | 960 | 650 | 480 |
| 600 | End | 900 | 900 | 900 | 830 | 550 | 380 | 280 |
| | Internal | 1200 | 1200 | 1200 | 1200 | 960 | 650 | 480 |
| 900 | End | 900 | 890 | 890 | 650 | 440 | 300 | 220 |
| | Internal | 900 | 900 | 900 | 1120 | 750 | 510 | 380 |
| 1200 | End | 900 | 890 | 670 | 490 | 330 | 220 | 160 |
| | Internal | 900 | 900 | 900 | 840 | 560 | 380 | 280 |

Trimdek / Monoclad Roof Profile (Grade G550)

| Rafter Spacing (mm) | Type of Span | 0.48mm BMT Non Cyclonic Wind Classification | | | 0.55mm BMT Cyclonic Wind Classification Low-High-Low Certified | | | |
|---------------------|--------------|---|------|------|--|-----|-----|-----|
| | | N1 | N2 | N3 | C1 | C2 | C3 | C5 |
| 450 | End | 900 | 900 | 900 | 650 | 440 | 300 | 220 |
| | Internal | 1200 | 1200 | 1200 | 1120 | 750 | 510 | 380 |
| 600 | End | 900 | 900 | 900 | 650 | 440 | 300 | 220 |
| | Internal | 1120 | 1120 | 1120 | 1120 | 750 | 510 | 380 |
| 900 | End | 890 | 890 | 890 | 650 | 440 | 300 | 220 |
| | Internal | 900 | 900 | 900 | 1120 | 750 | 510 | 380 |
| 1200 | End | 890 | 800 | 670 | 490 | 330 | 220 | 160 |
| | Internal | 900 | 900 | 900 | 840 | 560 | 380 | 280 |

Fastener Details

Sheeting To Battens

| | |
|----------------|---------------------------------|
| Non - cyclonic | 12 - 11 x 50 Type 17 Class 3 |
| Cyclonic | 14 - 10 x 50 Type 17 Class 3 |

Battens To Timber Rafters

| | |
|---------------------------------------|---|
| Screw Fixed | 2/12 - 11 x 40 Type 17 Class 3 (J2, J3, JD4, JD5) |
| Nail Fixed | |
| Hardwood - J2, J3 (Non-Cyclonic) | 2/50 x 2.87 Round Head Nails |
| Softwood - JD4, JD5 (Non-Cyclonic) | 2/50 x 2.87 Round Head Nail |
| Hardwood - J2, J3 (Cyclonic) | 2/50 x 2.87 Grooved Nails |
| Softwood - JD4, JD5 (Cyclonic) | 2/75 x 3.06 Grooved Nails |

Local Pressure Areas

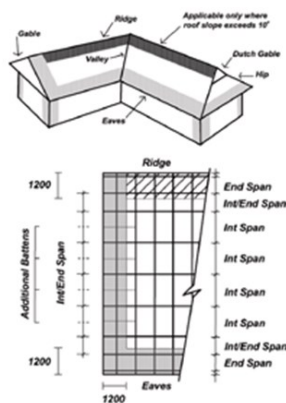

Batten Spacings:
Batten spacing must consider localised areas of increased pressure at roof edges and ridges. If necessary, additional battens may be used for local pressure areas extending along gable ends. For fastener fixing layouts and more detailed information on installation of roof cladding refer to the relevant roofing data sheet.

Hips, Valleys & Corners

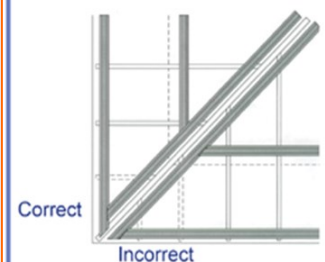

NB: Fix edge battens before fixing hip & valley battens

Laps



For further information, please contact Interline Manufacturing at:
43 Morrisby Street
Geebung Qld 4034
T: (07) 3265 6677
F: (07) 3265 6699
www.interlineman.com
sales@interlineman.com